



**SUBMITTAL**

**TYPE:** SEP-G ASME AIR SEPARATOR  
WITH GROOVED SYSTEM CONNECTIONS

**MODELS:** SEP 2G TO SEP 24G

**Submittal Sheet No.** B-3301G

**Date:** 5/03

<p><b>JOB</b></p> <p>Unit Tag No. _____</p> <p>Engineer _____</p> <p>Contractor _____</p>	<p style="text-align: center;"><b>FLO FAB</b> Representative _____</p> <p>_____</p> <p>_____</p> <p>Order No. _____ Date _____</p> <p>Submitted By _____ Date _____</p> <p>Approved By _____ Date _____</p>
---	---

**DESCRIPTION**

Flo Fab SEP Vortex type Air Separators eliminate air quickly and efficiently from open and closed loop heating/cooling systems. Water enters and exits through unique "tangential" connections, which promote a low velocity swirling effect in the center of the unit. Natural centrifugal forces allow the heavier air-free water to move towards the outer edges while entrained air is captured within the "eye" of the vortex and released out the top of the separator. The water then exits near the bottom of the unit, bubble free, protecting the system against the noise, corrosion, and damage commonly caused by entrained air.

**CONSTRUCTION**

Shell: Carbon steel  
Heads: Carbon steel

**PERFORMANCE LIMITATIONS**

Maximum Design Pressure: 125 PSIG  
Maximum Design Temperature: 450°F

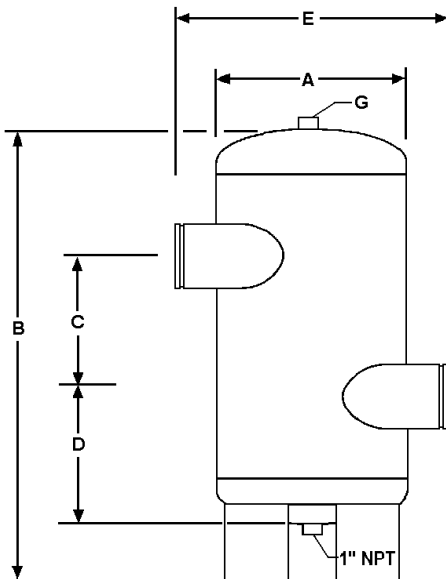

Model Number	Max GPM	Conn. Size	Type	Dimensions in inches							Approx. Lbs.
				A	B	C	D	E	F	G	
SEP 2G	56	2	GROOVED	12	22 1/2	5 1/2	8 1/2	16 5/8	9 1/2	1 1/4	50
SEP 2-1/2G	90	2.5	GROOVED	12	22 1/2	5 1/2	8 1/2	16 5/8	9 1/2	1 1/4	55
SEP 3G	190	3	GROOVED	12	22 1/2	5 3/4	8	19 3/4	9 1/2	1 1/4	60
SEP 4G	300	4	GROOVED	14	32	9 1/8	10 3/4	21 3/4	11 1/2	1 1/2	90
SEP 5G	530	5	GROOVED	14	32	9 1/8	10 3/4	21 3/4	11 1/2	1 1/2	148
SEP 6G	850	6	GROOVED	20	44	13 1/4	14 1/2	28	18	2	191
SEP 8G	1900	8	GROOVED	20	44	13 1/4	14 1/2	28	18	2	379
SEP 10G	3200	10	GROOVED	30	60 1/2	19	20	41	24	2	598
SEP 12G	4800	12	GROOVED	30	60 1/2	19	20	41	24	2	947
SEP 14G	6100	14	GROOVED	36	78	22	31 1/2	46 3/8	30	2	1680
SEP 16G	8000	16	GROOVED	48	108	30	40	60	38	2	2300
SEP 18G	9700	18	GROOVED	48	124	33	50	60	44	2	3235
SEP 20G	12000	20	GROOVED	54	138	35	60	60	50	2	5100
SEP 22G	15000	22	GROOVED	60	150	38	66	72	56	2	6150
SEP 24G	17000	24	GROOVED	66	160	40	72	78	62	2	7210

**TYPICAL SPECIFICATION**

Furnish and install as shown on plans, a vortex type air separator Model SEP \_\_\_\_\_ sized for \_\_\_\_\_ GPM, with \_\_\_\_\_" grooved tangential connections as manufactured by Flo Fab. The air separator shall be designed in accordance with the latest revisions of the ASME Code for Boilers and Pressure Vessels, Section VIII, Division 1, and shall be constructed and stamped for 125 PSI working pressure @ 450°F. A blowdown connection shall be provided to facilitate routine cleaning of the unit. Each air separator shall be Flo Fab SEP \_\_\_\_\_ or approved equal.